

Clamshell buckets



Compact clamshell bucket with horizontal piston to move materials in general useful on any loading machinery.



TECHNICAL DATA

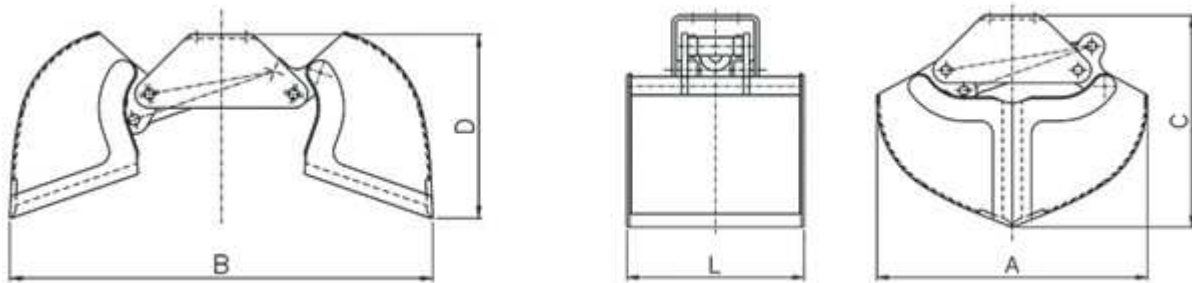

MODEL	L	Weight kg	Teeth optional	MAX bar	A mm	B mm	C mm	D mm	L mm	Max capacity kg	Closing ability daN
BM 35	35	35	3	200	456	624	357	304	305	100	433
BM 50	50	52	4	200	626	895	492	390	330	150	821
BM 100	90	85	4	200	770	1.100	605	480	350	200	974
BM 125	125	134	4	200	840	1.200	660	523	450	250	1.737
BM 150	155	143	4	200	840	1.200	660	523	550	350	1.737
BM 175	175	152	4	200	840	1.200	660	523	650	350	1.737
BM 200	205	161	6	200	840	1.200	660	523	750	450	1.737
BM 225	225	170	6	200	840	1.200	660	523	850	450	1.737
BM 325	320	208	6	200	1.040	1.430	780	565	800	700	1.477
BM 350	360	220	8	200	1.040	1.430	780	565	900	700	1.477
BM 425	400	232	8	200	1.040	1.430	780	565	1.000	700	1.477
BM 300SX	300	287	4	200	1.208	1.830	900	620	630	1.300	1.524
BM500SX	460	305	6	200	1.206	1.830	900	620	830	1.300	1.524
BM600SX	580	323	8	200	1.206	1.830	900	600	1.030	1.300	1.524

Standard block valve

